

#### Features

1. Opaque type, mini-flat package.
2. Subminiature type (The volume is smaller than that of our conventional DIP type by as far as 30%).
3. Isolation voltage between input and output Viso: 3750Vrms.
4. Employs double transfer mold technology.
5. Recognized by UL and CUL, file NO. E225308.
6. Approved by VDE 0884 Teil2 (NO: 40017614).
7. Package: 1000Pcs / Reel.
8. Moisture sensitivity level : level 4.
9. RoHS Compliant.

#### Applications

1. Hybrid substrates that require high density mounting.
2. Programmable controllers.

#### \*PACKAGE DIMENSIONS (UNIT:mm) SMD Type

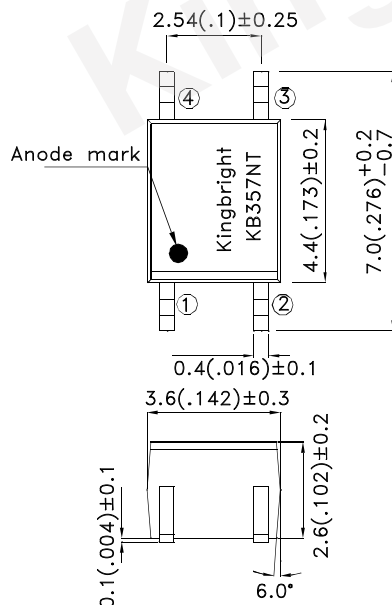

Internal connection diagram

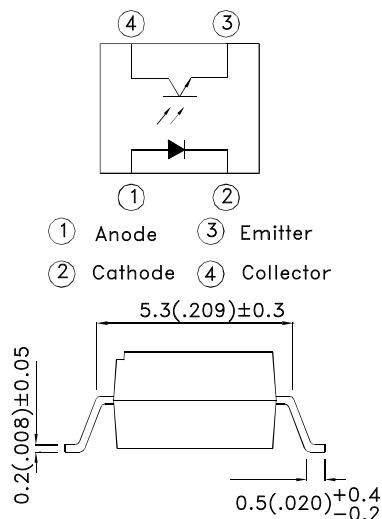

UNIT : MM[INCH]  
TOLERANCE :  $\pm 0.5[\pm 0.02]$  UNLESS OTHERWISE NOTED.



#### \*Absolute Maximum Ratings (Ta=25°C)

Parameter		Symbol	Rating	Unit
Input	Forward current	IF	50	mA
	Reverse Voltage	VR	6	V
	Power dissipation	P	70	mW
Output	Collector-emitter voltage	VCEO	35	V
	Emitter-collector voltage	VECO	6	V
	Collector current	IC	50	mA
	Collector power dissipation	Pc	150	mW
Total power dissipation		Ptot	170	mW
*1 Isolation voltage		Viso	3750	Vrms
Operating temperature		Topr	-30 to +100	°C
Storage temperature		Tstg	-40 to +125	°C
*2 Soldering temperature		Tsol	260	°C

\*1 40 to 60%RH, AC for 1 minute.

\*2 For 10 seconds.

#### \*Electro-optical Characteristics

Parameter			Symbol	Conditions	Min.	Typ.	Max.	Unit
Input	Forward voltage		V <sub>F</sub>	I <sub>F</sub> =20mA	-	1.2	1.4	V
	Peak forward voltage		V <sub>FM</sub>	I <sub>FM</sub> =0.5A	-	-	3.0	V
	Reverse Current		I <sub>R</sub>	V <sub>R</sub> =4V	-	-	10	uA
Output	Collector dark current		I <sub>CEO</sub>	V <sub>ce</sub> =20V I <sub>F</sub> =0V	-	-	10 <sup>-7</sup>	A
Transfer characteristics	Current transfer ratio		CTR	I <sub>F</sub> =5mA V <sub>ce</sub> =5V	50	-	600	%
	Collector-emitter saturation voltage		V <sub>CE (sat)</sub>	I <sub>F</sub> =20mA I <sub>c</sub> =1mA	-	-	0.2	V
	Response time	Rise time	t <sub>r</sub>	V <sub>ce</sub> =2V I <sub>c</sub> =2mA R <sub>L</sub> =100Ω	-	4	18	uS
		Fall time	t <sub>f</sub>		-	3	18	uS

Model No.	Rank mark	CTR(%)
KB357NLT	L	50 to 100
KB357N1T	A	80 to 160
KB357N2T	B	130 to 260
KB357N3T	C	200 to 400
KB357N4T	D	300 to 600
KB357N5T	A or B	80 to 260
KB357N6T	B or C	130 to 400
KB357N7T	C or D	200 to 600
KB357N8T	A,B or C	80 to 400
KB357N9T	B,C or D	130 to 600
KB357N0T	A,B,C or D	80 to 600
KB357NT	L,A,B,C,D or No mark	50 to 600

**Fig. 1 Current Transfer Ratio vs. Forward Current**

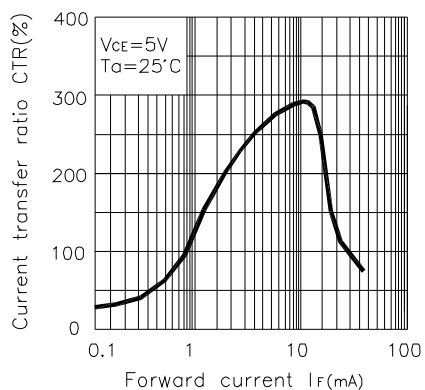

**Fig. 2 Forward Current vs. Forward Voltage**

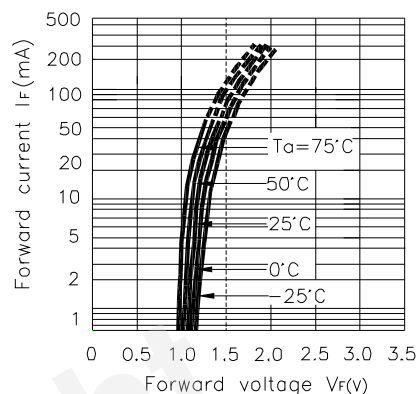

**Fig. 3 Collector Current vs. Collector-emitter Voltage**

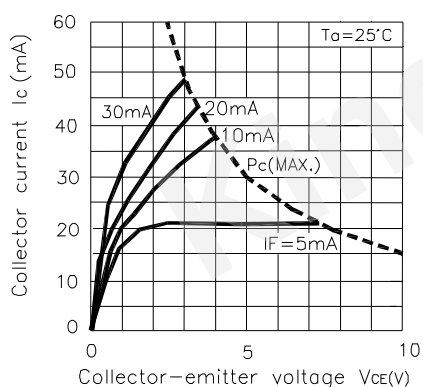

**Fig. 4 Relative Current Transfer Ratio vs. Ambient Temperature**

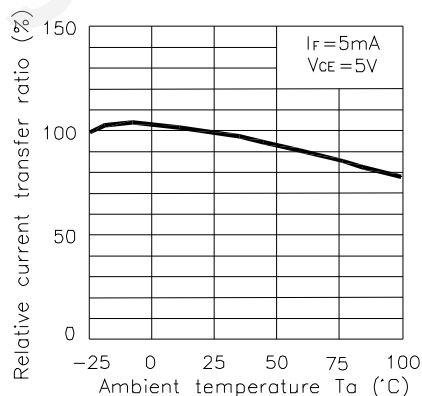

**Fig. 5 Collector-emitter Saturation Voltage vs. Ambient Temperature**

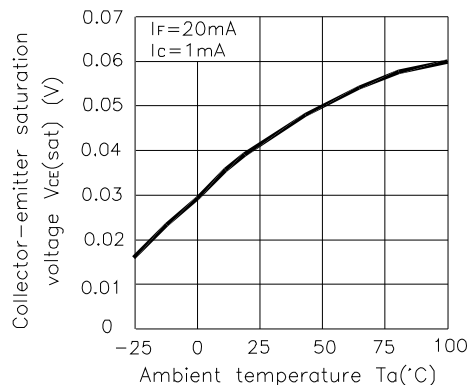

**Fig. 6 Response Time vs. Load Resistance**

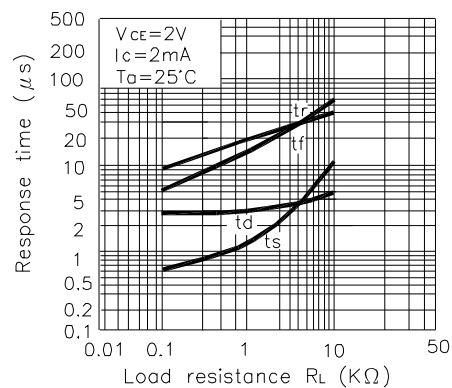

**Fig. 7 Collector-emitter Saturation Voltage vs. Forward Current**

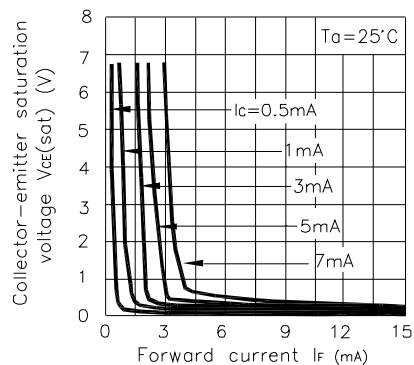

**Fig. 8 Collector Dark Current vs. Ambient Temperature**

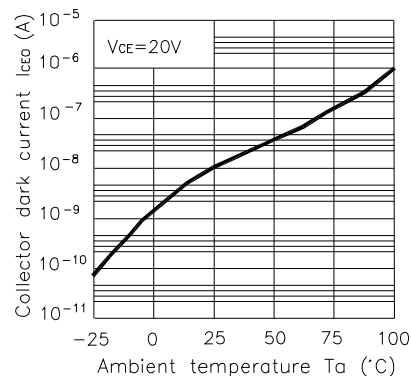

**Test Circuit for Response Time**

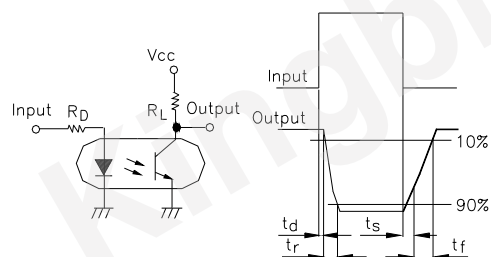

#### \*NOTES ON HANDLING

##### 1.Cautions regarding noise

Be aware that power is suddenly into the component any surge current may cause damage happen, even if the voltage is within the absolute maximum ratings.

Reflow Soldering Profile For Lead-free SMT Process.

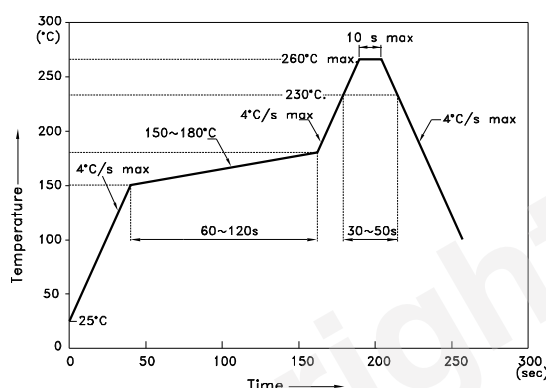

#### NOTES:

1. We recommend the reflow temperature 245°C(+/-5°C). The maximum soldering temperature should be limited to 260°C.
2. Don't cause stress to the epoxy resin while it is exposed to high temperature.
3. Number of reflow process shall be 2 times or less.

#### CAUTION

Within this device there exists GaAs (Gallium Arsenide) material which is a harmful substance if ingested. GaAs dust and fumes are toxic. Do not break, cut or pulverize the product, or use chemicals to dissolve them.

#### RESTRICTIONS ON PRODUCT USE

- The information in this document is subject to change without notice. Before using this document, please confirm that this is the latest version. Not all devices / types available in every country.
- We mention about our product quality stability, semiconductor devices in general can malfunction or fail due to their inherent electrical sensitivity and vulnerability to physical stress. It is the responsibility of the buyer, when utilizing KINGBRIGHT products, to observe standards of safety, and to avoid situations in which a malfunction or failure of a KINGBRIGHT product could cause loss of human life, bodily injury or damage to property. In developing your designs, please ensure that KINGBRIGHT products are used within specified operating ranges as set forth in the most recent products specifications.

Part Number: KB357NT

### Outline and Dimension (Tape) (Units : mm)

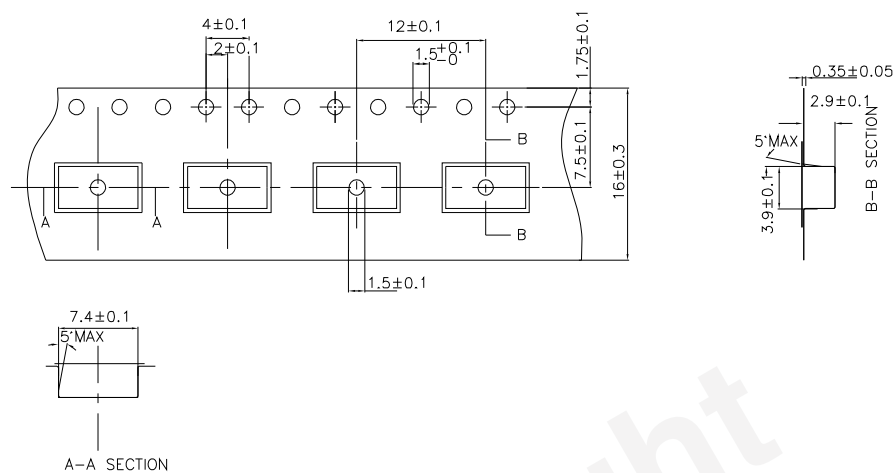

### Tape Direction

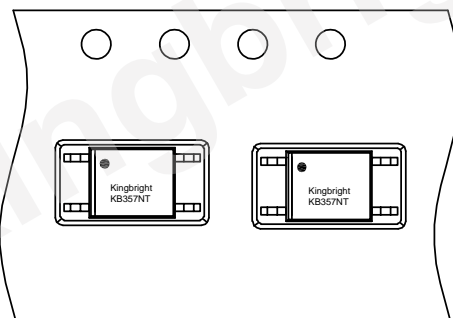

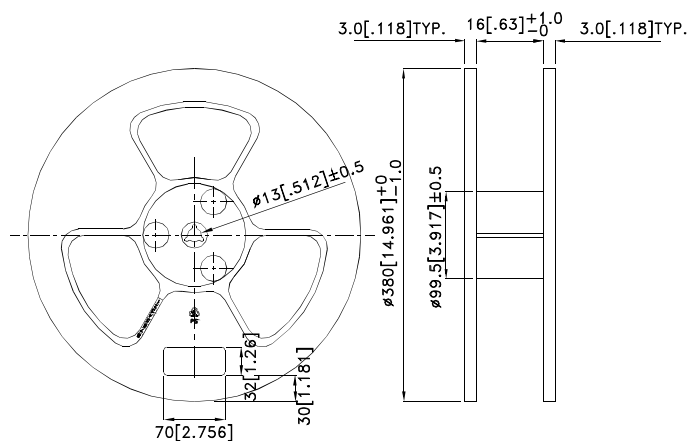

### Outline and Dimension (Reel)

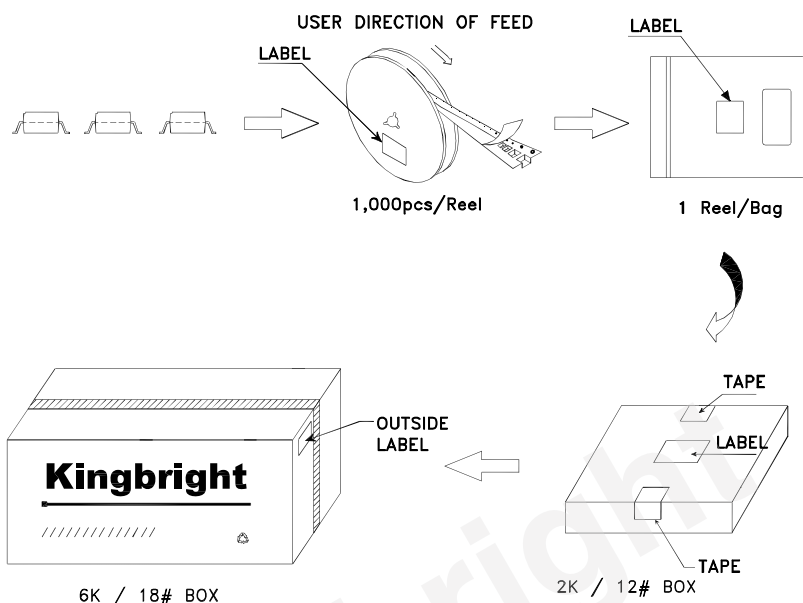

Packing: 1000pcs/reel

#### PACKING & LABEL SPECIFICATIONS



<b>Kingbright</b>	
P/NO: KB357xxx	
QTY: 1,000 pcs	Q.C. <span style="border: 1px solid black; border-radius: 50%; padding: 2px;">Q C XX XX XXXX PASSED</span>
S/N: XXXX	
CODE: XXX	
LOT NO:	
	
RoHS Compliant	

#### Terms and conditions for the usage of this document

1. The information included in this document reflects representative usage scenarios and is intended for technical reference only.
2. The part number, type, and specifications mentioned in this document are subject to future change and improvement without notice. Before production usage customer should refer to the latest datasheet for the updated specifications.
3. When using the products referenced in this document, please make sure the product is being operated within the environmental and electrical limits specified in the datasheet. If customer usage exceeds the specified limits, Kingbright will not be responsible for any subsequent issues.
4. The information in this document applies to typical usage in consumer electronics applications. If customer's application has special reliability requirements or have life-threatening liabilities, such as automotive or medical usage, please consult with Kingbright representative for further assistance.
5. The contents and information of this document may not be reproduced or re-transmitted without permission by Kingbright.
6. All design applications should refer to Kingbright application notes available at [http://www.kingbright.com/application\\_notes](http://www.kingbright.com/application_notes)