

Part Number: KB354NT

Customer Part Number: KB354NT

Kingbright

PHOTOCOUPLER

Features

- 1.AC inputs.
- 2.High current transfer ratio.
- 3.Opaque type, mini-flat package.
- 4.Subminiature type (The volume is smaller than that of our conventional DIP type by as far as 30%).
- 5.Isolation voltage between input and output Viso:3750Vrms.
- 6.Emloys double transfer mold technology.
- 7.Recognized by UL and CUL, file NO.E225308.
- 8.Approved by VDE 0884 Teil2(NO:40017614).
- 9.Package : 1000Pcs / Reel.
- 10.Moisture sensitivity level : level 4.
- 11.RoHS Compliant.

Applications

- 1.Hybrid substrates that require high density mounting.

*PACKAGE DIMENSIONS (UNIT:mm) SMD Type

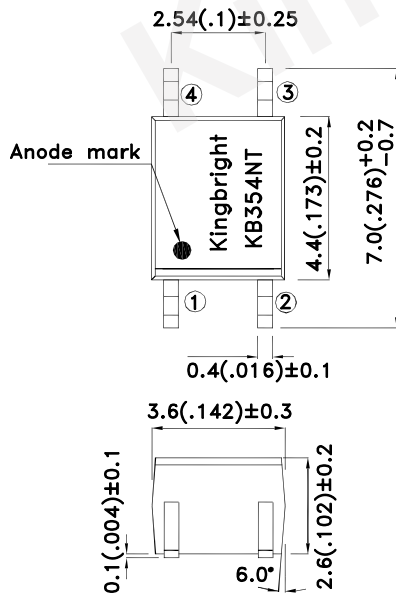

Internal connection diagram

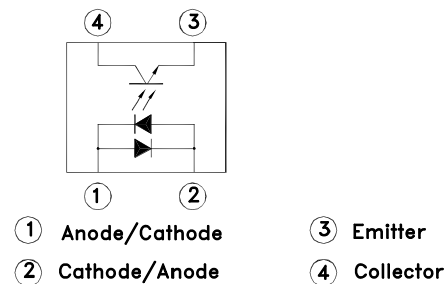

UNIT : MM[INCH]
TOLERANCE : $\pm 0.5[\pm 0.02]$ UNLESS OTHERWISE NOTED.



Part Number: KB354NT

Customer Part Number: KB354NT

Kingbright**PHOTOCOUPLER*****Absolute Maximum Ratings (Ta=25°C)**

Parameter		Symbol	Rating	Unit
Input	Forward current	IF	±50	mA
	Power dissipation	P	70	mW
Output	Collector-emitter voltage	V _{CEO}	35	V
	Emitter-collector voltage	V _{ECO}	6	V
	Collector current	IC	50	mA
	Collector power dissipation	P _c	150	mW
Total power dissipation		P _{tot}	170	mW
*1 Isolation voltage		V _{iso}	3750	V _{rms}
Operating temperature		T _{opr}	-30 to +100	°C
Storage temperature		T _{stg}	-40 to +125	°C
*2 Soldering temperature		T _{sol}	260	°C

*1 40 to 60%RH, AC for1 minute.

*2 For 10 seconds.

***Electro-optical Characteristics**

Parameter			Symbol	Conditions	Min.	Typ.	Max.	Unit
Input	Forward voltage		V _F	I _F =± 20mA	-	1.2	1.4	V
	Peak forward voltage		V _{FM}	I _{FM} =0.5A	-	-	3.0	V
Output	Collector dark current		I _{CEO}	V _{ce} =20V I _F =0	-	-	10 ⁻⁷	A
	Collector-emitter breakdown voltage		BV _{CEO}	I _C =0.1mA I _F =0	35	-	-	V
	Emitter-collector breakdown voltage		BV _{ECO}	I _E =10uA I _F =0	6	-	-	V
Transfer characteristics	Current transfer ration		CTR	I _F =± 1mA V _{ce} =5V	20	-	400	%
	Collector-emitter saturation voltage		V _{CE (sat)}	I _F =± 20mA I _C =1mA	-	0.1	0.2	V
	Response time	Rise time	t _r	V _{ce} =2V I _C =2mA R _L =100Ω	-	4	18	uS
		Fall time	t _f		-	3	18	uS

Model No.	Rank mark	CTR(%)
KB354N1T	A	50 to 150
KB354NT	L	20 to 50
	A	50 to 150
	B	150 to 300

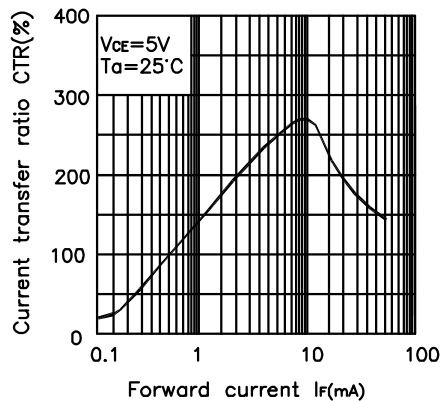
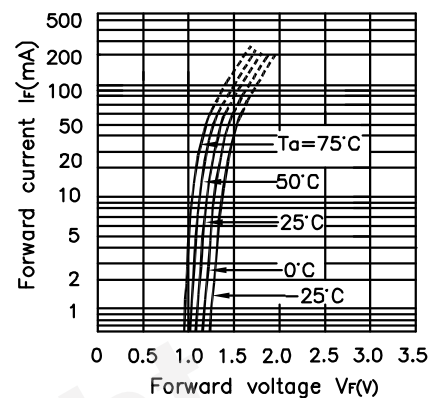
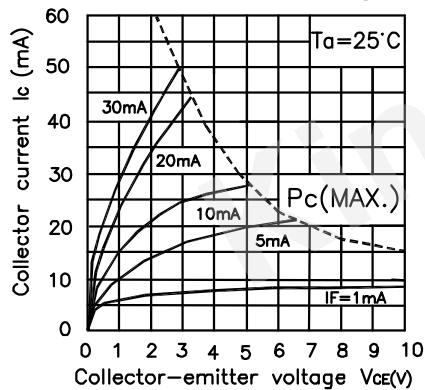
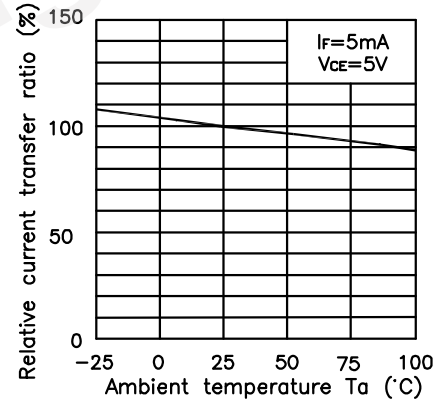
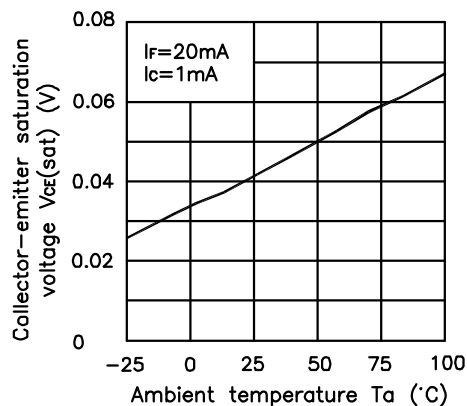
Kingbright**PHOTOCOUPLER****Fig. 1 Current Transfer vs. Forward Current****Fig. 2 Forward Current vs. Forward voltage****Fig. 3 Collector Current vs. Collector-emitter Voltage****Fig. 4 Forward Current vs. Ambient Temperature****Fig. 5 Collector-emitter Saturation Voltage vs. Ambient Temperature**

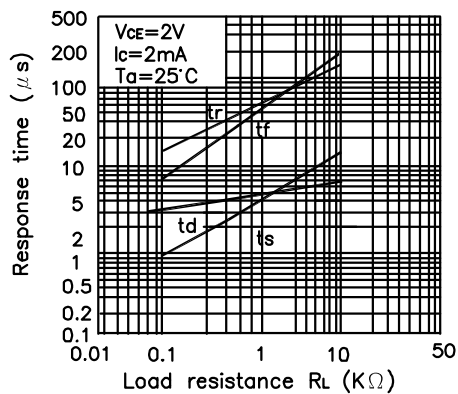
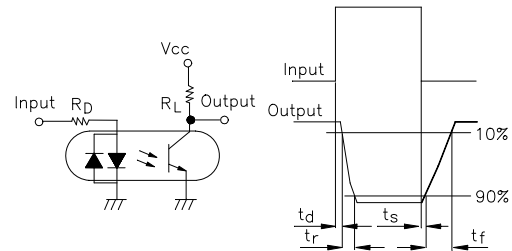
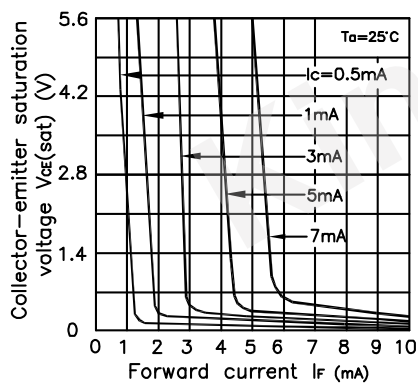
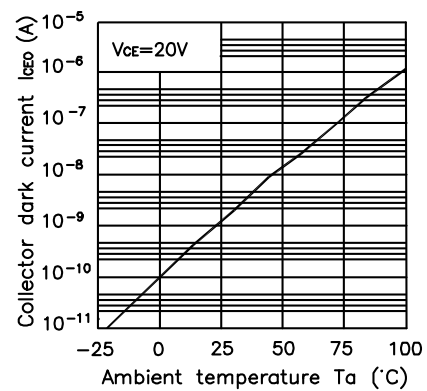
Kingbright**PHOTOCOUPLER****Fig. 6 Response Time vs. Load Resistance****Test Circuit for Response Time****Fig. 7 Collector-emitter Saturation Voltage vs. Forward Current****Fig. 8 Collector Dark Current vs. Ambient Temperature**

Kingbright**PHOTOCOUPLER*****NOTES ON HANDLING****1.Cautions regarding noise**

Be aware that power is suddenly into the componment any surge current may cause damage happen, even if the voltage is within the absolute maximum ratings.

Reflow Soldering Profile For Lead-free SMT Process.

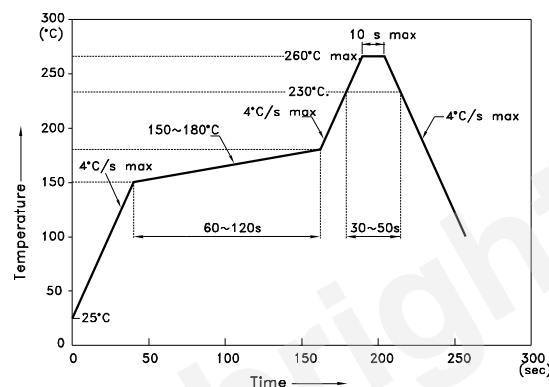
**NOTES:**

1. We recommend the reflow temperature 245°C(+/-5°C). The maximum soldering temperature should be limited to 260°C.
2. Don't cause stress to the epoxy resin while it is exposed to high temperature.
3. Number of reflow process shall be 2 times or less.

CAUTION

Within this device there exists GaAs (Gallium Arsenide) material which is a harmful substance if ingested. GaAs dust and fumes are toxic. Do not break, cut or pulverize the product, or use chemicals to dissolve them.

RESTRICTIONS ON PRODUCT USE

- The information in this document is subject to change without notice. Before using this document, please confirm that this is the latest version. Not all devices / types available in every country.
- We are mention about our product quality stablity, semiconductor devices in general can malfunction or fail due to their inherent electrical sensitivty and vulnerability to physical stress. It is the responsibility of the buyer, when utilizing KINGBRIGHT products, to observe standards of safety, and to a avoid situations in which a malfunction or failure of a KINGBRIGHT product could cause loss of human life, bodily injury or damage to property. In developing your designs, please ensure that KINGBRIGHT products are used within specified operating ranges as set forth in the most recent products specifications.

Customer Part Number: KB354NT

Kingbright

PHOTOCOUPLER

Outline and Dimension (Tape) (Units : mm)

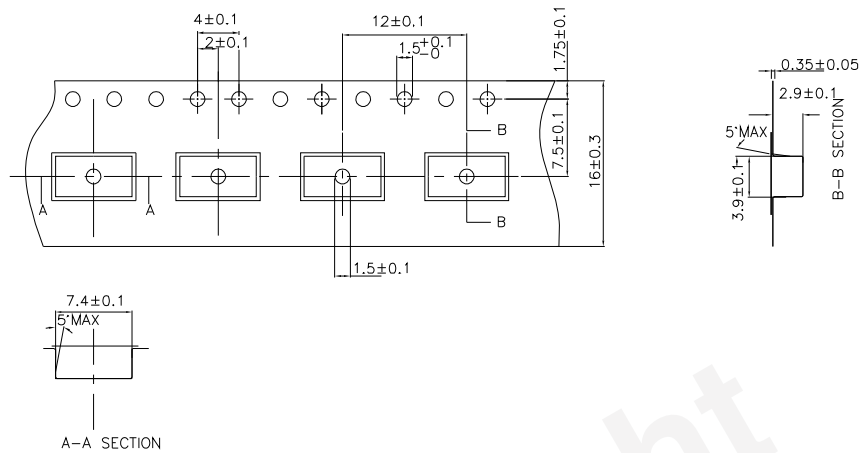

Tape Direction

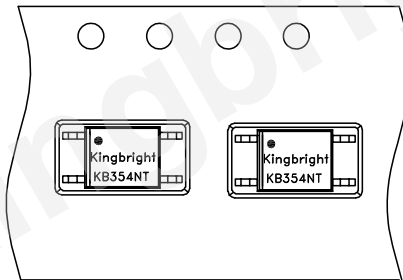

Outline and Dimension (Reel)

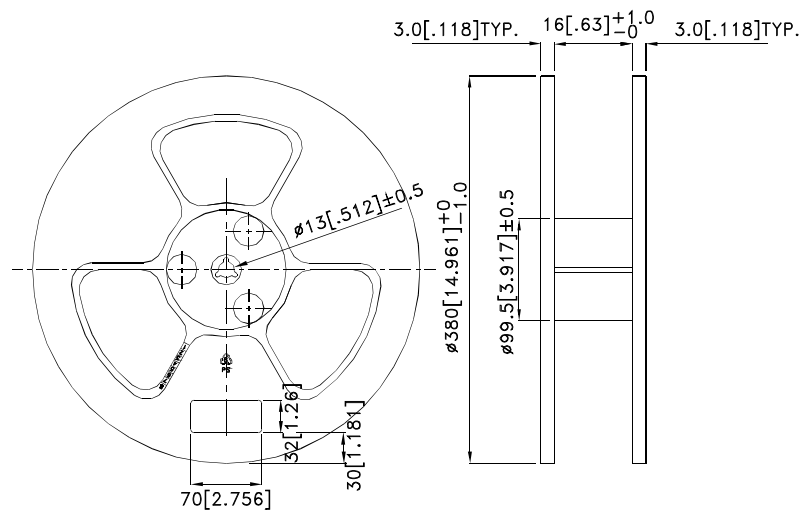

Packing:1000pcs/reel

Part Number: KB354NT

Customer Part Number: KB354NT

Kingbright

PHOTOCOUPLER

PACKING & LABEL SPECIFICATIONS

KB354NT

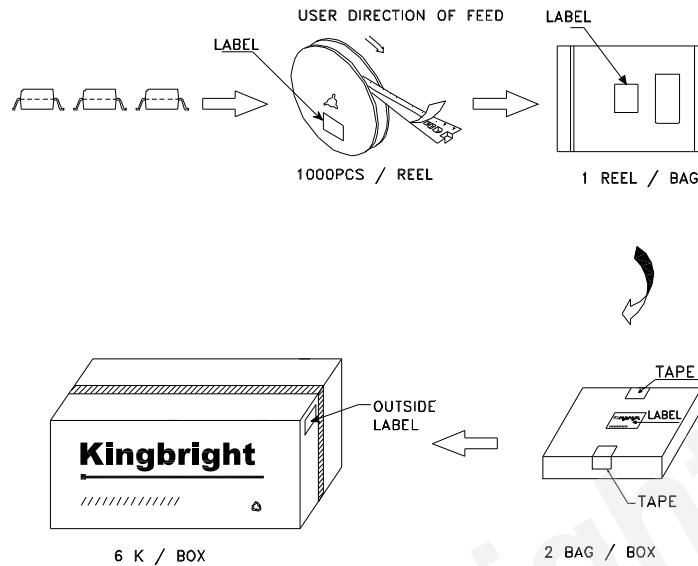

Kingbright	
P/NO: KB354xxx	
QTY: 1000 pcs	Q.C. Q C XX XX XXXX PASSED
S/N: XXXX	
CODE: XXX	
LOT NO:  XXXXXXXXXX	
RoHS Compliant	

Terms and conditions for the usage of this document

- 1.The information included in this document reflects representative usage scenarios and is intended for technical reference only.
- 2.The part number, type, and specifications mentioned in this document are subject to future change and improvement without notice. Before production usage customer should refer to the latest datasheet for the updated specifications.
- 3.When using the products referenced in this document, please make sure the product is being operated within the environmental and electrical limits specified in the datasheet. If customer usage exceeds the specified limits, Kingbright will not be responsible for any subsequent issues.
- 4.The information in this document applies to typical usage in consumer electronics applications. If customer's application has special reliability requirements or have life-threatening liabilities, such as automotive or medical usage, please consult with Kingbright representative for further assistance.
- 5.The contents and information of this document may not be reproduced or re-transmitted without permission by Kingbright.
- 6.All design applications should refer to Kingbright application notes available at http://www.kingbright.com/application_notes